

**.75 Brambles Farm Drive
Uxbridge, UB10 0DY**

£1,800 Per Month

****STUDENTS****

3 BEDROOMS - AVAILABLE 03/07/2026

The rental payments equate to approx £600 per person per month or £138 per person per week excluding bills. UniHomes offer a bills package for £30 per person per week. (Incl Gas, Electric, Water, TV licence and internet) which can be organised through Nupad initially.

Nupad offer this excellent Three-bedroom house comprising of THREE FURNISHED BEDROOMS , a LOUNGE/dining room BATHROOM with separate wc AND KITCHEN facilities, Outside there is and enclosed rear garden and resident parking

The property is ideal for students at Brunel University. It is also nearby to direct bus routes to Uxbridge Town Centre, Heathrow, Stockley Park and the local underground station, which provides further access to Central London.

COUNCIL TAX BAND D
EPC C

.75 Brambles Farm Drive, Uxbridge, UB10 0DY



ENTRANCE FLOOR
526 sq.ft. (48.9 sq.m.) approx.

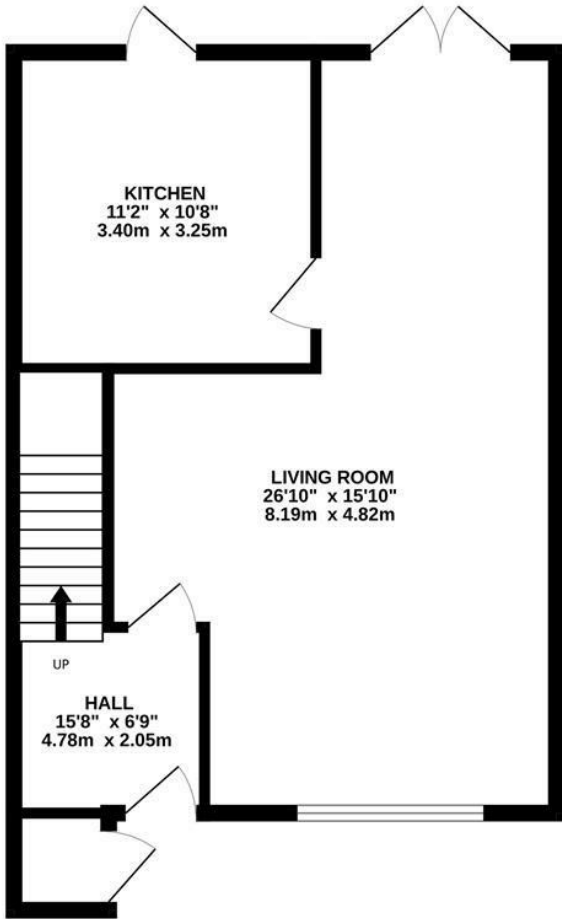

FIRST FLOOR
405 sq.ft. (37.6 sq.m.) approx.

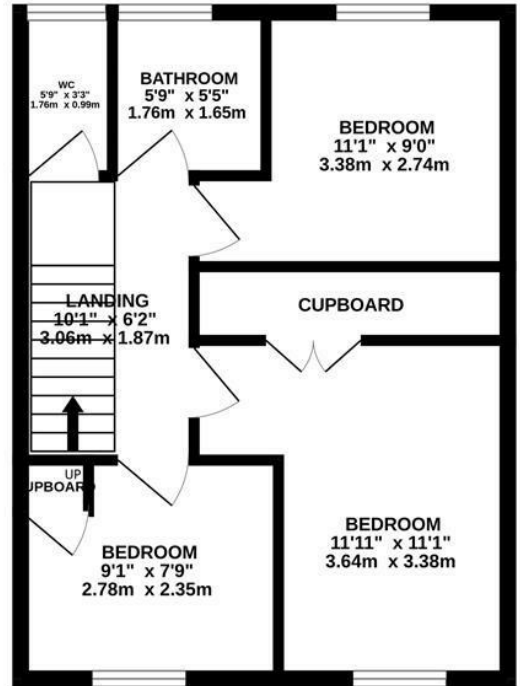

TOTAL FLOOR AREA : 931 sq.ft. (86.5 sq.m.) approx.

Whilst every attempt has been made to ensure the accuracy of the floorplan contained here, measurements of doors, windows, rooms and any other items are approximate and no responsibility is taken for any error, omission or mis-statement. This plan is for illustrative purposes only and should be used as such by any prospective purchaser. The services, systems and appliances shown have not been tested and no guarantee as to their operability or efficiency can be given.
Made with Metropix ©2026

Energy Efficiency Rating		Current	Potential
Very energy efficient - lower running costs			
(92 plus) A			
(81-91) B			
(69-80) C			
(55-68) D			
(39-54) E			
(21-38) F			
(1-20) G			
Not energy efficient - higher running costs			
England & Wales		EU Directive 2002/91/EC	

Environmental Impact (CO ₂) Rating		Current	Potential
Very environmentally friendly - lower CO ₂ emissions			
(92 plus) A			
(81-91) B			
(69-80) C			
(55-68) D			
(39-54) E			
(21-38) F			
(1-20) G			
Not environmentally friendly - higher CO ₂ emissions			
England & Wales		EU Directive 2002/91/EC	